

# RADIAL CHOKE COIL

**SERIE:** BCR0506 6,5 x 5,0 mm

## DIMENSIONS:

VPE: 800pcs. Try



RoHS Compliant

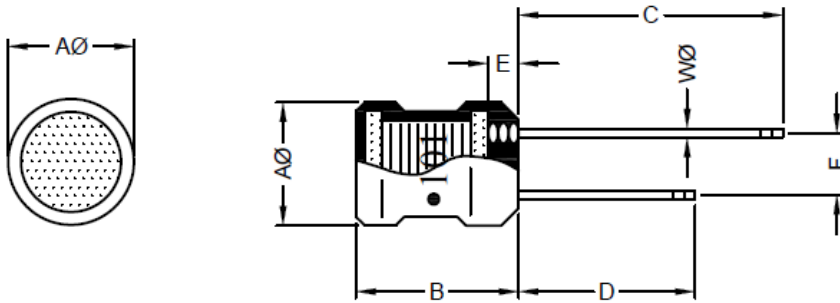

Marking :

" ● " : Start

Unit:m/m

AØ	B	C	D	E	F	WØ
5.00±0.5	6.50 <sup>+1.0</sup> / <sub>-0.5</sub>	20.00±5.0	15.00±5.0	2.50 Max.	2.00±0.50	0.50 Ref.

## SCHEMATIC:

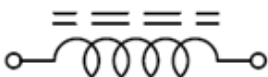

## GENERAL SPECIFICATION :

1. The inductance drop at rated is 10% max.
2. Temp. rise. 40°C max. at rated current.
3. Storage temp. : -40°C.....+125°C
4. Operating temp.: -40°C.... +85°C

## MATERIALS:

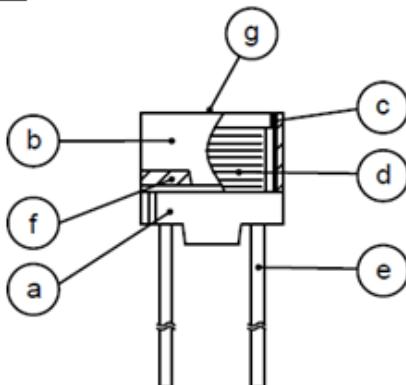

- (a) DR CORE
- (b) RI CORE
- (c) SLEEVE
- (d) WIRE
- (e) LEAD
- (f) ADHESIVE
- (g) INK

NOTE : Specifications subject to change without notice. Please check our website for latest information

# **RADIAL CHOKE COIL**

**SERIE:** BCR0506 6,5 x 5,0 mm



## **ELECTRICAL CHARACTERISTICS**

Part. No	Inductance ( $\mu$ H)	Q	Test Frequency (Hz)	SRF (MHz.)	RDC ( $\Omega$ ) Max.	IDC (mA) Max.
<b>BCR0506 - 1R0SWE</b>	1,0	60	1V/7,96M	105,0	0,10	1030
<b>BCR0506 - 1R2SWE</b>	1,2	60	1V/7,96M	90,0	0,15	980
<b>BCR0506 - 1R5SWE</b>	1,5	60	1V/7,96M	75,0	0,20	920
<b>BCR0506 - 1R8SWE</b>	1,8	60	1V/7,96M	70,0	0,20	880
<b>BCR0506 - 2R2SWE</b>	2,2	60	1V/7,96M	65,0	0,24	830
<b>BCR0506 - 2R7SWE</b>	2,7	60	1V/7,96M	60,0	0,27	790
<b>BCR0506 - 3R3SWE</b>	3,3	60	1V/7,96M	50,0	0,30	750
<b>BCR0506 - 3R9SWE</b>	3,9	60	1V/7,96M	45,0	0,30	720
<b>BCR0506 - 4R7SWE</b>	4,7	60	1V/7,96M	40,0	0,35	670
<b>BCR0506 - 5R6SWE</b>	5,6	60	1V/7,96M	35,0	0,35	640
<b>BCR0506 - 6R8SWE</b>	6,8	60	1V/7,96M	30,0	0,40	620
<b>BCR0506 - 8R2SWE</b>	8,2	60	1V/7,96M	25,0	0,40	590
<b>BCR0506 - 100SWE</b>	10,0	60	1V/2,52M	20,0	0,45	550
<b>BCR0506 - 120SWE</b>	12,0	60	1V/2,52M	15,0	0,50	530
<b>BCR0506 - 150SWE</b>	15,0	60	1V/2,52M	13,0	0,55	500
<b>BCR0506 - 180SWE</b>	18,0	60	1V/2,52M	11,0	0,60	480
<b>BCR0506 - 220SWE</b>	22,0	60	1V/2,52M	10,0	0,65	460
<b>BCR0506 - 270SWE</b>	27,0	50	1V/2,52M	9,0	0,75	430
<b>BCR0506 - 330SWE</b>	33,0	50	1V/2,52M	8,0	0,85	410
<b>BCR0506 - 390SWE</b>	39,0	50	1V/2,52M	7,5	0,90	390

*NOTE : Specifications subject to change without notice. Please check our website for latest information*

# **RADIAL CHOKE COIL**

**SERIE:** BCR0506 6,5 x 5,0 mm



## **ELECTRICAL CHARACTERISTICS**

Part. No	Inductance ( uH )	Q	Test Frequency ( Hz )	SRF (MHz.)	RDC ( Ω ) Max.	IDC ( mA ) Max.
BCR0506 - 470SWE	47,0	50	1V/2,52M	7,0	1,00	370
BCR0506 - 560SWE	56,0	50	1V/2,52M	6,5	1,20	350
BCR0506 - 680SWE	68,0	50	1V/2,52M	6,0	1,30	340
BCR0506 - 820SWE	82,0	50	1V/2,52M	5,5	1,50	320
BCR0506 - 101SWE	100,0	50	1V/0,796M	5,0	1,70	305
BCR0506 - 121SWE	120,0	50	1V/0,796M	4,8	1,90	290
BCR0506 - 151SWE	150,0	50	1V/0,796M	4,4	2,10	275
BCR0506 - 181SWE	180,0	50	1V/0,796M	4,2	2,30	235
BCR0506 - 221SWE	220,0	45	1V/0,796M	3,8	2,50	200
BCR0506 - 271SWE	270,0	45	1V/0,796M	3,6	2,75	180
BCR0506 - 331SWE	330,0	45	1V/0,796M	3,3	4,68	165
BCR0506 - 391SWE	390,0	45	1V/0,796M	3,0	6,00	150
BCR0506 - 471SWE	470,0	45	1V/0,796M	2,8	6,50	140
BCR0506 - 561SWE	560,0	45	1V/0,796M	2,4	8,50	135
BCR0506 - 681SWE	680,0	45	1V/0,796M	2,2	9,00	125
BCR0506 - 821SWE	820,0	45	1V/0,796M	2,0	9,60	120
BCR0506 - 102SWE	1000,0	45	1V/0,252M	1,8	11,50	100

*NOTE : Specifications subject to change without notice. Please check our website for latest information.*