

# RADIAL CHOKE COIL

**SERIE:** BCR0812 12,0 x 8,7 mm

## DIMENSIONS:

VPE: 200pcs. Try



RoHS Compliant

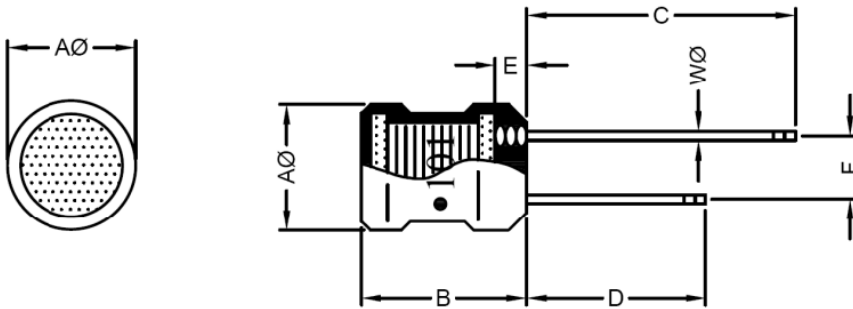

Marking :

" ● " : Start

Unit : mm

Aφ	B	C	D	E	F	Wφ
8.70±0.5	12.0±1.0	25.0±5.0	18.0±5.0	2.50 Max.	5.00±0.8	0.65±0.1

## SCHEMATIC:

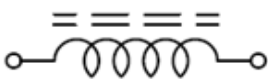

## GENERAL SPECIFICATION :

1. The inductance drop at rated is 10% max.
2. Temp. rise. 40°C max. at rated current.
3. Storage temp.: -40°C.....+125°C
4. Operating temp.: -40°C.... +85°C

## MATERIALS:

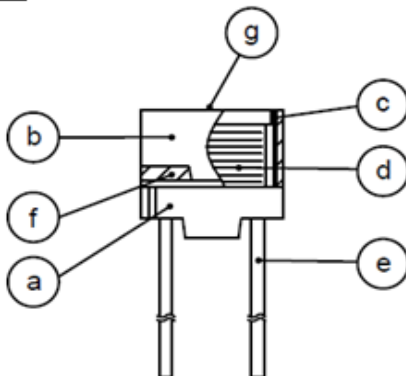

- (a) DR CORE
- (b) RI CORE
- (c) SLEEVE
- (d) WIRE
- (e) LEAD
- (f) ADHESIVE
- (g) INK

NOTE : Specifications subject to change without notice. Please check our website for latest information

# **RADIAL CHOKE COIL**

**SERIE:** BCR0812 12,0 x 8,7 mm



COILS ■ ELEKTRONIK ■ TRANSFORMERS

## **ELECTRICAL CHARACTERISTICS**

Part. No	Inductance ( $\mu\text{H}$ ) 20%	Q	Test Frequency (Hz)	SRF (MHz.)	RDC ( $\Omega$ ) Max.	IDC (A) Max.
<b>BCR0812 - 3R3SWE</b>	3,3	9	1V/7,96M	70,0	0,027	3,6
<b>BCR0812 - 4R7SWE</b>	4,7	9	1V/7,96M	50,0	0,033	3,2
<b>BCR0812 - 6R8SWE</b>	6,8	9	1V/7,96M	30,0	0,039	3
<b>BCR0812 - 100SWE</b>	10,0	10	1V/2,52M	20,0	0,048	2,7
<b>BCR0812 - 120SWE</b>	12,0	10	1V/2,52M	15,0	0,055	2,5
<b>BCR0812 - 150SWE</b>	15,0	10	1V/2,52M	10,0	0,060	2,4
<b>BCR0812 - 180SWE</b>	18,0	10	1V/2,52M	9,5	0,065	2,3
<b>BCR0812 - 220SWE</b>	22,0	15	1V/2,52M	9,0	0,090	1,9
<b>BCR0812 - 270SWE</b>	27,0	15	1V/2,52M	8,5	0,11	1,8
<b>BCR0812 - 330SWE</b>	33,0	15	1V/2,52M	8,0	0,12	1,7
<b>BCR0812 - 390SWE</b>	39,0	15	1V/2,52M	7,0	0,13	1,6
<b>BCR0812 - 470SWE</b>	47,0	15	1V/2,52M	6,0	0,14	1,5
<b>BCR0812 - 560SWE</b>	56,0	15	1V/2,52M	5,0	0,20	1,3
<b>BCR0812 - 680SWE</b>	68,0	15	1V/2,52M	4,5	0,21	1,2
<b>BCR0812 - 820SWE</b>	82,0	15	1V/2,52M	4,0	0,23	1,1
<b>BCR0812 - 101SWE</b>	100,0	20	1V/0,796M	3,5	0,28	1
<b>BCR0812 - 121SWE</b>	120,0	20	1V/0,796M	3,0	0,32	0,9
<b>BCR0812 - 151SWE</b>	150,0	20	1V/0,796M	2,8	0,37	0,8
<b>BCR0812 - 181SWE</b>	180,0	20	1V/0,796M	2,6	0,54	0,75
<b>BCR0812 - 221SWE</b>	220,0	20	1V/0,796M	2,4	0,60	0,7
<b>BCR0812 - 271SWE</b>	270,0	20	1V/0,796M	2,20	0,68	0,65

*NOTE : Specifications subject to change without notice. Please check our website for latest information*

# **RADIAL CHOKE COIL**

**SERIE:** BCR0812 12,0 x 8,7 mm



COILS ■ ELEKTRONIK ■ TRANSFORMERS

## **ELECTRICAL CHARACTERISTICS**

Part. No	Inductance ( uH ) 20%	Q	Test Frequency ( Hz )	SRF (MHz.)	RDC ( Ω ) Max.	IDC ( A ) Max.
<b>BCR0812 - 331SWE</b>	330,0	20	1V/0,796M	2,00	0,76	0,6
<b>BCR0812 - 391SWE</b>	390,0	20	1V/0,796M	1,90	0,85	0,55
<b>BCR0812 - 471SWE</b>	470,0	20	1V/0,796M	1,80	1,30	0,5
<b>BCR0812 - 561SWE</b>	560,0	20	1V/0,796M	1,70	1,40	0,45
<b>BCR0812 - 681SWE</b>	680,0	20	1V/0,796M	1,60	1,60	0,4
<b>BCR0812 - 821SWE</b>	820,0	20	1V/0,796M	1,50	1,80	0,35
<b>BCR0812 - 102SWE</b>	1000,0	20	1V/0,252M	1,30	2,10	0,3

*NOTE : Specifications subject to change without notice. Please check our website for latest information*