

RADIAL CHOKE COIL

SERIE: BCR1823 23,0 x 18,0 mm

DIMENSIONS:

VPE: 100pcs. Try



RoHS Compl

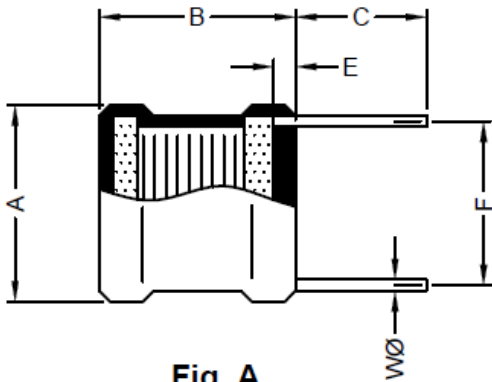

Fig. A

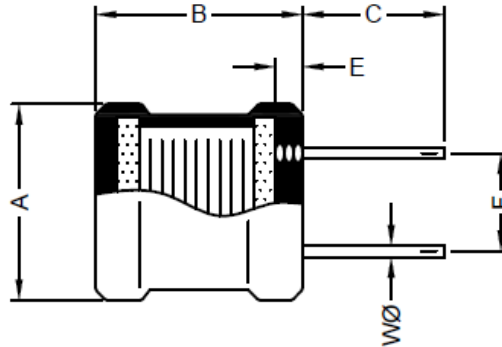
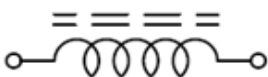

Fig. B

Unit:m/m

A	B	C	E
18.0 Max.	23.0 Max.	15.0±5.0	15.0±5.0

SCHEMATIC:



GENERAL SPECIFICATION :

1. The inductance drop at rated is 10% max.
2. Temp. rise. 40°C max. at rated current.
3. Storage temp.: -40°C.....+125°C
4. Operating temp.: -40°C..... +85°C

MATERIALS:

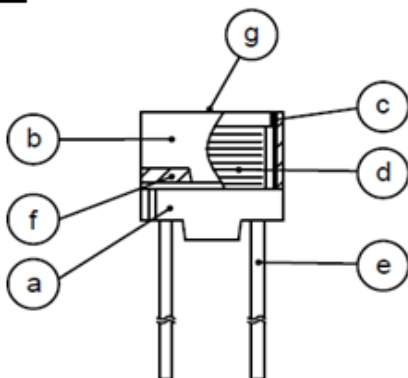

- (a) DR CORE
- (b) RI CORE
- (c) SLEEVE
- (d) WIRE
- (e) LEAD
- (f) ADHESIVE
- (g) INK

NOTE : Specifications subject to change without notice. Please check our website for latest information

RADIAL CHOKE COIL

SERIE: BCR1823 23,0 x 18,0 mm



ELECTRICAL CHARACTERISTICS

Part. No	Inductance (μ H) 20%	Test Frequency (Hz)	RDC (Ω) Max.	IDC (A) Max.	Dimension		Fig.
					F m/m	W m/m	
BCR1823 - 100SWE	10	1V/1K	0,009	8,0	14,0	1,2	A
BCR1823 - 250SWE	25	1V/1K	0,022	6,0	14,0	1,0	A
BCR1823 - 500SWE	50	1V/1K	0,036	4,0	14,0	1,0	A
BCR1823 - 101SWE	100	1V/1K	0,090	3,0	9,0	1,0	B
BCR1823 - 251SWE	250	1V/1K	0,150	2,0	9,0	1,0	B
BCR1823 - 501SWE	500	1V/1K	0,300	1,2	9,0	1,0	B
BCR1823 - 102SWE	1000	1V/1K	0,600	1,0	9,0	1,0	B

NOTE : Specifications subject to change without notice. Please check our website for latest information.