

SMD POWER INDUCTORS" LowProfile"

SERIE: DLI3015 3,0 x 3,0 x 1,5 mm

DIMENSIONS:

VPE: 3000 pcs.



RoHS Compliant

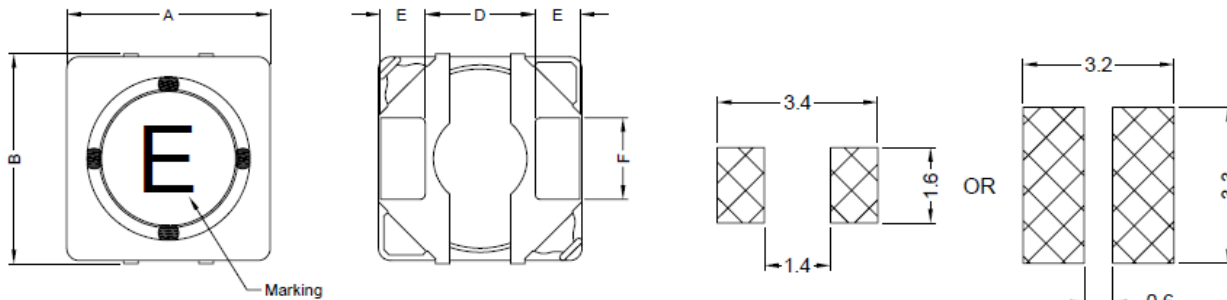

Recommended PCB Pattern



Unit:m/m

A	B	C	D	E	F	G
3.0±0.2	3.0±0.3	1.5 Max.	1.5 Typ.	0.76 Typ.	1.2 Typ.	0.7 Typ.

SCHEMATIC:



MATERIALS:

Core: Ferrite

GENERAL SPECIFICATION :

1. IDC1: Based on inductance change ($\Delta L/L0A : \leq 30\%$) @ ambient temp. 25°C
2. IDC2: Based on temperature rise ($\Delta T: 40^\circ\text{C Typ.}$)
3. Rated Current: IDC1 or IDC2, whichever value is lower
4. Storage temp. : -40°C.....+105°C
5. Operating temp.: -40°C.....+105°C (include self temp. rise)
6. Resistance to solder heat : 260°C 10sec.

NOTE : Specifications subject to change without notice. Please check our website for latest information

SMD POWER INDUCTORS" LowProfile"

SERIE: DLI3015 3,0 x 3,0 x 1,5 mm



ELECTRICAL CHARACTERISTICS

Part. No.	Inductance (uH)		Test Frequency (Hz)	RDC (mΩ) ± 20%	IDC (A)	IDC (2)	Marking
DLI3015 - 1R0SWE	1,0	30%	0,1V / 100K	52	2,3	1,84	A
DLI3015 - 1R5SWE	1,5	30%	0,1V / 100K	70	2	1,66	C
DLI3015 - 1R8SWE	1,8	30%	0,1V / 100K	80	1,7	1,56	D
DLI3015 - 2R2SWE	2,2	30%	0,1V / 100K	90	1,5	1,4	E
DLI3015 - 2R7SWE	2,7	30%	0,1V / 100K	100	1,4	1,3	F
DLI3015 - 3R3SWE	3,3	30%	0,1V / 100K	110	1,3	1,25	G
DLI3015 - 3R9SWE	3,9	30%	0,1V / 100K	120	1,2	1,2	H
DLI3015 - 4R7SWE	4,7	20%	0,1V / 100K	160	1	1,1	I
DLI3015 - 5R6SWE	5,6	20%	0,1V / 100K	170	0,9	1,05	J
DLI3015 - 6R8SWE	6,8	20%	0,1V / 100K	230	0,85	1	K
DLI3015 - 8R2SWE	8,2	20%	0,1V / 100K	280	0,8	0,95	L
DLI3015 - 100SWE	10	20%	0,1V / 100K	360	0,75	0,85	M
DLI3015 - 120SWE	12	20%	0,1V / 100K	420	0,62	0,77	N
DLI3015 - 150SWE	15	20%	0,1V / 100K	500	0,58	0,67	O
DLI3015 - 180SWE	18	20%	0,1V / 100K	590	0,54	0,56	P
DLI3015 - 220SWE	22	20%	0,1V / 100K	720	0,48	0,5	Q
DLI3015 - 270SWE	27	20%	0,1V / 100K	820	0,40	0,45	R

NOTE : Specifications subject to change without notice. Please check our website for latest information.