

# SMD POWER INDUCTORS

**SERIE:** PCF5020 5,0 x 4,9 x 2,0 mm

## DIMENSIONS:

VPE: 3000 pcs.



RoHS Compliant

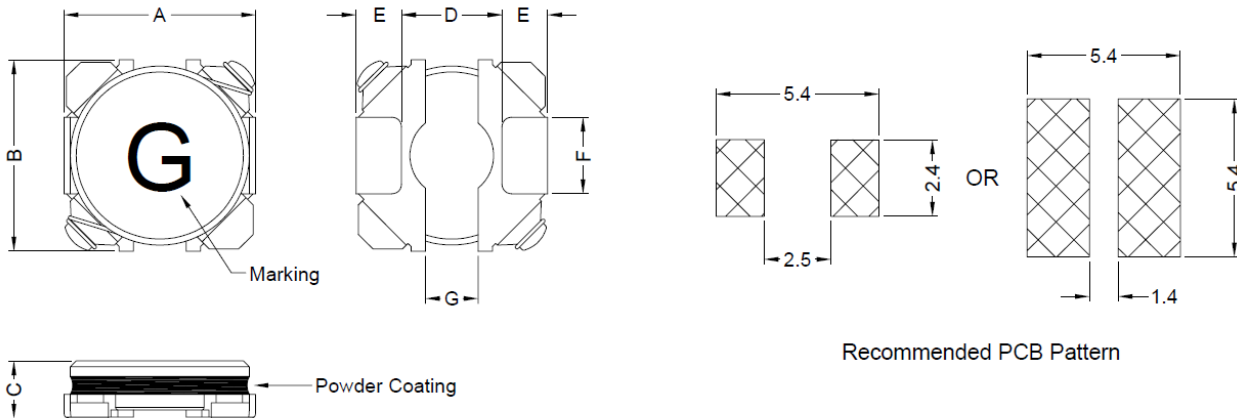

Recommended PCB Pattern

Unit:m/m

A	B	C	D	E	F	G
5.0±0.2	4.9±0.2	2.0 Max.	2.7 Typ	1.16 Typ	2.0 Typ	1.5 Typ

## SCHEMATIC:

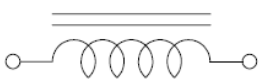

## MATERIALS:

Core: Ferrite

## GENERAL SPECIFICATION :

1. IDC1: Based on inductance change ( $\Delta L/L0A : \leq 30\%$  ) @ ambient temp. 25°C
2. IDC2: Based on temperature rise ( $\Delta T: 40^\circ\text{C Typ.}$ )
3. Rated Current: IDC1 or IDC2, whichever value is lower
4. Storage temp. : -40°C.....+105°C
5. Operating temp.: -40°C.....+105°C ( include self temp. rise )
6. Resistance to solder heat : 260°C 10sec.

*NOTE : Specifications subject to change without notice. Please check our website for latest information*

# SMD POWER INDUCTORS

**SERIE:** PCF5020 5,0 x 4,9 x 2,0 mm



## ELECTRICAL CHARACTERISTICS

Part. No.	Inductance (uH)		Test Frequency ( Hz)	RDC ( mΩ ) ± 20%	IDC (A)	IDC (2)	Marking
-----------	-----------------	--	----------------------	------------------	---------	---------	---------

PCF5020 - 1R0SWE	1,0	30%	0,1V / 100K	48	5,60	2,10	A
PCF5020 - 1R2SWE	1,2	30%	0,1V / 100K	58	4,70	1,95	B
PCF5020 - 1R5SWE	1,5	30%	0,1V / 100K	66	4,20	1,80	C
PCF5020 - 2R2SWE	2,2	30%	0,1V / 100K	77	3,40	1,70	E
PCF5020 - 3R3SWE	3,3	30%	0,1V / 100K	89	2,80	1,65	G
PCF5020 - 3R9SWE	3,9	30%	0,1V / 100K	97	2,60	1,60	H
PCF5020 - 4R7SWE	4,7	20%	0,1V / 100K	110	2,40	1,50	I
PCF5020 - 6R8SWE	6,8	20%	0,1V / 100K	140	2,20	1,35	K
PCF5020 - 100SWE	10	20%	0,1V / 100K	170	2,00	1,20	M
PCF5020 - 150SWE	15	20%	0,1V / 100K	230	1,50	1,05	O
PCF5020 - 220SWE	22	20%	0,1V / 100K	350	1,20	0,85	Q
PCF5020 - 330SWE	33	20%	0,1V / 100K	480	1,00	0,70	S
PCF5020 - 470SWE	47	20%	0,1V / 100K	670	0,90	0,55	U

NOTE : Specifications subject to change without notice. Please check our website for latest information.