

RADIAL CHOKE COIL

SERIE: REP0606 6,0 x 6,50 mm

DIMENSIONS:

VPE: 200 pcs. BOX



RoHS Compliant

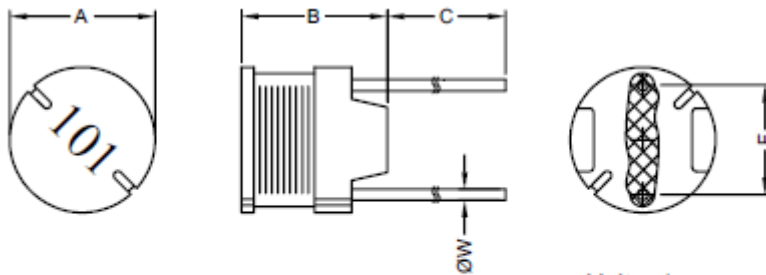

Unit:m/m

A	B	C	F	ØW
6.0±0.5	6.5 Max.	20.0±5.0	4.0±0.5	0.50±0.10

SCHEMATIC:



GENERAL SPECIFICATION :

1. The inductance drop at rated is 10% max.
2. Temp. rise. 40°C max. at rated current.
3. Storage temp. : -40°C.....+105°C
4. Operating temp.: -40°C.... +85°C

MATERIALS:

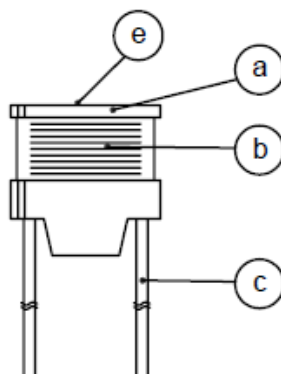

- (a) Core : DR Ferrite Core
- (b) Wire : Enamelled Copper Wire
- (c) Lead : Tinned Copper Wire
- (d) Adhesive : Epoxy
- (e) Ink : Bon Margue

NOTE : Specifications subject to change without notice. Please check our website for latest information

RADIAL CHOKE COIL

SERIE: REP0606 6,0 x 6,50 mm



ELECTRICAL CHARACTERISTICS

Part. No.	Inductance (uH)		Test Frequency (Hz)	RDC (Ω)	IDC (A)
-----------	-----------------	--	----------------------	-----------	---------

REP0606 - 220SWE	22	10%	2,52M	0,11	1,27
REP0606 - 270SWE	27	10%	2,52M	0,14	1,14
REP0606 - 330SWE	33	10%	2,52M	0,17	1,03
REP0606 - 390SWE	39	10%	2,52M	0,19	0,95
REP0606 - 470SWE	47	10%	2,52M	0,23	0,87
REP0606 - 560SWE	56	10%	2,52M	0,26	0,80
REP0606 - 860SWE	68	10%	2,52M	0,28	0,72
REP0606 - 820SWE	82	10%	2,52 M	0,39	0,66
REP0606 - 101SWE	100	10%	1K	0,43	0,59
REP0606 - 121SWE	120	10%	1K	0,54	0,54
REP0606 - 151SWE	150	10%	1K	0,64	0,48
REP0606 - 181SWE	180	10%	1K	0,74	0,44
REP0606 - 221SWE	220	10%	1K	0,96	0,40
REP0606 - 271SWE	270	10%	1K	1,12	0,36
REP0606 - 331SWE	330	10%	1K	1,48	0,33
REP0606 - 391SWE	390	10%	1K	1,66	0,30
REP0606 - 471SWE	470	10%	1K	1,91	0,27
REP0606 - 561SWE	560	10%	1K	2,31	0,25
REP0606 - 681SWE	680	10%	1K	2,67	0,23
REP0606 - 821SWE	820	10%	1K	3,10	0,21
REP0606 - 102SWE	1000	10%	1k	4,45	0,19

NOTE : Specifications subject to change without notice. Please check our website for latest information.