

RADIAL CHOKE COIL

SERIE: REP0805 7,8 x 5,50 mm

DIMENSIONS:

VPE: 160 Tray



RoHS Compliant

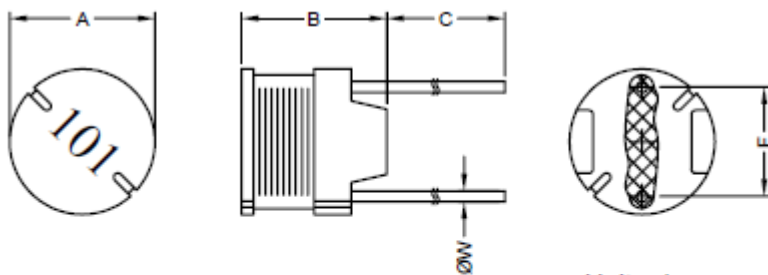

Unit:m/m

A	B	C	F	ØW
7.80±0.50	5.50 Max.	15.00±3.00	5.00±0.50	0.65±0.10

SCHEMATIC:



GENERAL SPECIFICATION :

1. The inductance drop at rated is 10% max.
2. Temp. rise. 40°C max. at rated current.
3. Storage temp.: -40°C.....+105°C
4. Operating temp.: -40°C.... +85°C

MATERIALS:

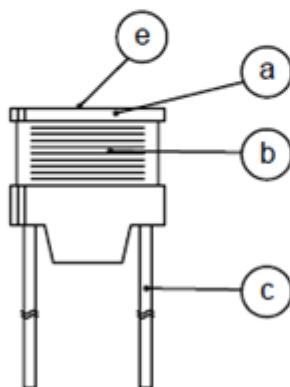

- (a) Core : DR Ferrite Core
- (b) Wire : Enamelled Copper Wire
- (c) Lead : Tinned Copper Wire
- (d) Adhesive : Epoxy
- (e) Ink : Bon Margue

NOTE : Specifications subject to change without notice. Please check our website for latest information

RADIAL CHOKE COIL

SERIE: REP0805 7,8 x 5,50 mm



ELECTRICAL CHARACTERISTICS

Part. No.	Inductance (uH)		Test Frequency (Hz)	RDC (Ω)	IDC (A)
-----------	-----------------	--	----------------------	------------------	---------

REP0805 - 100SWE	10	10%	2,52M	0,07	2,50
REP0805 - 120SWE	12	10%	2,52M	0,08	2,40
REP0805 - 150SWE	15	10%	2,52M	0,09	2,10
REP0805 - 180SWE	18	10%	2,52M	0,10	2,00
REP0805 - 220SWE	22	10%	2,52M	0,12	1,70
REP0805 - 270SWE	27	10%	2,52M	0,14	1,60
REP0805 - 330SWE	33	10%	2,52M	0,17	1,40
REP0805 - 390SWE	39	10%	2,52 M	0,21	1,30
REP0805 - 470SWE	47	10%	2,52 M	0,24	1,20
REP0805 - 560SWE	56	10%	2,52 M	0,31	1,10
REP0805 - 680SWE	68	10%	2,52 M	0,34	1,00
REP0805 - 820SWE	82	10%	2,52 M	0,40	0,93
REP0805 - 101SWE	100	10%	1K	0,52	0,81
REP0805 - 121SWE	120	10%	1K	0,59	0,76
REP0805 - 151SWE	150	10%	1K	0,71	0,67
REP0805 - 181SWE	180	10%	1K	0,89	0,62
REP0805 - 221SWE	220	10%	1K	1,04	0,54
REP0805 - 271SWE	270	10%	1K	1,28	0,49
REP0805 - 331SWE	330	10%	1K	1,47	0,44
REP0805 - 391SWE	390	10%	1K	1,67	0,41
REP0805 - 471SWE	470	10%	1k	1,95	0,38
REP0805 - 561SWE	560	10%	1k	2,83	0,35
REP0805 - 681SWE	680	10%	1k	3,25	0,32
REP0805 - 821SWE	820	10%	1k	3,82	0,31
REP0805 - 102SWE	1000	10%	1k	5,28	0,25

NOTE : Specifications subject to change without notice. Please check our website for latest information.