

RADIAL CHOKE COIL

SERIE: REP1006 10,0 x 6,0 mm

DIMENSIONS:

VPE: 200 Box



RoHS Compliant

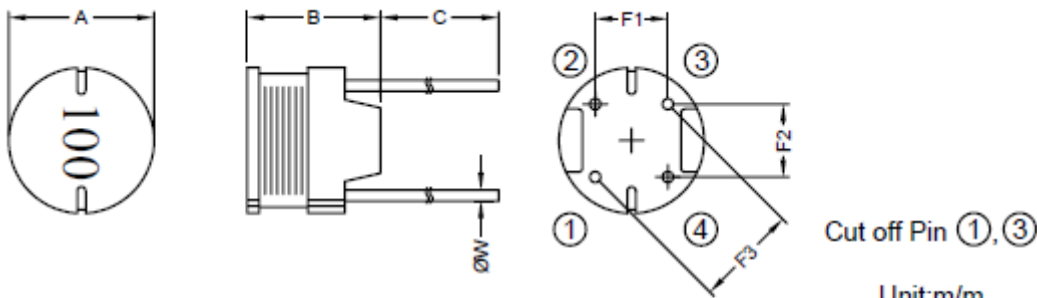

Unit:m/m

A	B	C	F1	F2	F3	ØW
10.0±0.5	6.0±0.5	15.0±3.0	4.0±0.5	5.0±0.5	6.4±0.5	0.65±0.10

SCHEMATIC:



GENERAL SPECIFICATION :

1. The inductance drop at rated is 10% max.
2. Temp. rise. 40°C max. at rated current.
3. Storage temp.: -40°C.....+105°C
4. Operating temp.: -40°C.... +85°C

MATERIALS:

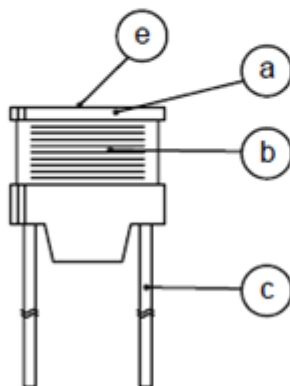

- (a) Core : DR Ferrite Core
- (b) Wire : Enamelled Copper Wire
- (c) Lead : Tinned Copper Wire
- (d) Adhesive : Epoxy
- (e) Ink : Bon Margue

NOTE : Specifications subject to change without notice. Please check our website for latest information

RADIAL CHOKE COIL

SERIE: REP1006 10,0 x 6,0 mm



ELECTRICAL CHARACTERISTICS

Part. No.	Inductance (uH)		Test Frequency (Hz)	RDC (Ω)	IDC (A)
-----------	-----------------	--	---------------------	---------	---------

REP1006 - 100SWE	10	20%	2,52M	0,040	3,60
REP1006 - 120SWE	12	20%	2,52M	0,044	3,30
REP1006 - 150SWE	15	20%	2,52M	0,058	2,90
REP1006 - 180SWE	18	20%	2,52M	0,064	2,70
REP1006 - 220SWE	22	20%	2,52M	0,088	2,40
REP1006 - 270SWE	27	10%	2,52M	0,10	2,20
REP1006 - 330SWE	33	10%	2,52M	0,11	2,00
REP1006 - 390SWE	39	10%	2,52 M	0,14	1,80
REP1006 - 470SWE	47	10%	2,52 M	0,16	1,70
REP1006 - 560SWE	56	10%	2,52 M	0,19	1,50
REP1006 - 680SWE	68	10%	2,52 M	0,22	1,40
REP1006 - 820SWE	82	10%	2,52 M	0,29	1,30
REP1006 - 101SWE	100	10%	1K	0,32	1,30
REP1006 - 121SWE	120	10%	1K	0,38	1,20
REP1006 - 151SWE	150	10%	1K	0,50	1,00
REP1006 - 181SWE	180	10%	1K	0,56	0,84
REP1006 - 221SWE	220	10%	1K	0,78	0,76
REP1006 - 271SWE	270	10%	1K	0,92	0,69
REP1006 - 331SWE	330	10%	1K	1,10	0,62
REP1006 - 391SWE	390	10%	1K	1,30	0,57
REP1006 - 471SWE	470	10%	1k	1,50	0,52
REP1006 - 561SWE	560	10%	1k	1,90	0,48
REP1006 - 681SWE	680	10%	1k	2,20	0,43
REP1006 - 821SWE	820	10%	1k	2,60	0,40
REP1006- 102SWE	1000	10%	1k	3,20	0,36

NOTE : Specifications subject to change without notice. Please check our website for latest information.