

MOLDED TYPE WIREWOUND CHIP INDUCTOR

SERIE: STW322522 3,2 x 2,5 x 2,2 mm

DIMENSIONS:

VPE: 2000pcs.



RoHS Compliant

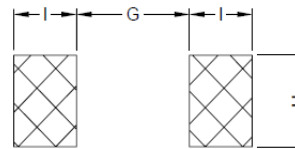
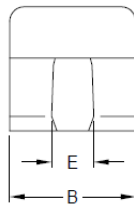
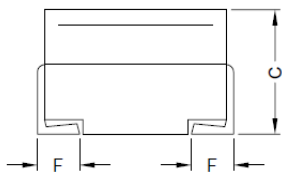
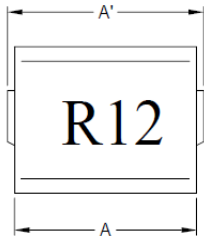

PCB Pattern

Unit:m/m

A'	A	B	C	E	F	G	H	I
3.2±0.4	2.9±0.2	2.5±0.2	2.2±0.2	1.0±0.3	0.6±0.2	1.8 Ref.	1.4 Ref.	1.0 Ref.

SCHEMATIC:

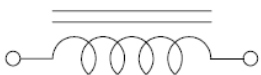

GENERAL SPECIFICATION :

- 1- Temp. rise: 20°C Max.
- 2- Ambient temp.: 100°C
- 3- Storage temp.: -40°C to + 125°C
- 4- Operating temp.: -40°C to + 125°C
- 5- Rated current: Current cause inductance drop within 10%
- 6- Resistance to solder heat: 260°C for 10 sec.
- 7- Resistance to solvent: Per MIL – STD- 202F

MATERIALS:

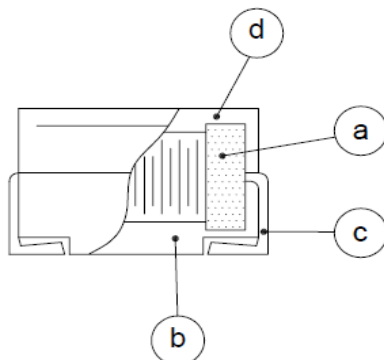

- (a) Core : DR Ferrite Core
- (b) Wire : Enamelled Copper Wire
- (c) Terminal : Tinned Copper Plate
- (d) Capsulate : Epoxy Novolac Molding Compound

NOTE : Specifications subject to change without notice. Please check our website for latest information.

MOLDED TYPE WIREWOUND CHIP INDUCTOR

SERIE: STW322522 3,2 x 2,5 x 2,2 mm



ELECTRICAL CHARACTERISTICS:

Part. No	L (μ H)	Q Min.	Test Frequency (MHz)	SRF (MHz.) Min.	RDC (Ω) Max.	IDC (mA) Max.
STW322522 – R12SWE *	0,12	30	25,2	500	0,22	450
STW322522 – R15SWE *	0,15	30	25,2	450	0,25	450
STW322522 – R18SWE *	0,18	30	25,2	400	0,28	450
STW322522 – R22SWE *	0,22	30	25,2	350	0,32	450
STW322522 – R27SWE *	0,27	30	25,2	320	0,36	450
STW322522 – R33SWE *	0,33	30	25,2	300	0,40	450
STW322522 – R39SWE *	0,39	30	25,2	250	0,45	450
STW322522 – R47SWE *	0,47	30	25,2	220	0,50	450
STW322522 – R56SWE *	0,56	30	25,2	180	0,55	450
STW322522 – R68SWE *	0,68	30	25,2	160	0,60	450
STW322522 – R82SWE *	0,82	30	25,2	140	0,65	450
STW322522 – 1R0SWE *	1,00	30	7,96	120	0,70	400
STW322522 – 1R2SWE *	1,20	30	7,96	100	0,75	390
STW322522 – 1R5SWE *	1,50	30	7,96	70	0,85	370
STW322522 – 1R8SWE *	1,80	30	7,96	60	0,90	350
STW322522 – 2R4SWE *	2,40	30	7,96	50	1,00	320
STW322522 – 2R7SWE *	2,70	30	7,96	45	1,10	290
STW322522 – 3R3SWE *	3,30	30	7,96	40	1,20	260
STW322522 – 3R9SWE *	3,90	30	7,96	37	1,30	250
STW322522 – 4R7SWE *	4,70	30	7,96	32	1,50	220
STW322522 – 5R6SWE *	5,60	30	7,96	30	1,60	200
STW322522 – 6R8SWE *	6,80	30	7,96	28	1,80	180
STW322522 – 8R2SWE *	8,20	30	7,96	25	2,00	170
STW322522 – 10SWE *	10	30	7,96	23	2,10	150
STW322522 – 12SWE *	12	30	7,96	20	2,50	140
STW322522 – 15SWE *	15	30	7,96	20	2,80	130

NOTE : Specifications subject to change without notice. Please check our website for latest information.

MOLDED TYPE WIREWOUND CHIP INDUCTOR

SERIE: STW322522 3,2 x 2,5 x 2,2 mm



ELECTRICAL CHARACTERISTICS:

Part. No	L (μ H)	Q Min.	Test Frequency (MHz)	SRF (MHz.) Min.	RDC (Ω) Max.	IDC (mA) Max.
STW322522 – 180SWE *	18	30	7,96	20	3,30	120
STW322522 – 220SWE *	22	30	7,96	20	3,70	110
STW322522 – 270SWE *	27	30	7,96	20	5,00	80
STW322522 – 330SWE *	33	30	7,96	17	5,60	70
STW322522 – 390SWE *	39	30	7,96	16	6,40	65
STW322522 – 470SWE *	47	30	7,96	15	7,00	60
STW322522 – 560SWE *	56	30	7,96	13	8,00	55
STW322522 – 680SWE *	68	30	7,96	12	9,00	50
STW322522 – 820SWE *	82	30	7,96	11	10,00	45
STW322522 – 101SWE *	100	20	7,96	10	11,00	40
STW322522 – 121SWE *	120	20	7,96	8	12,00	70
STW322522 – 151SWE *	150	20	7,96	8	16,00	65
STW322522 – 181SWE *	180	20	7,96	6	17,00	60
STW322522 – 221SWE *	220	20	7,96	6	21,00	50

* : J: 5%
K: 10%
M: 20%

NOTE : Specifications subject to change without notice. Please check our website for latest information.